

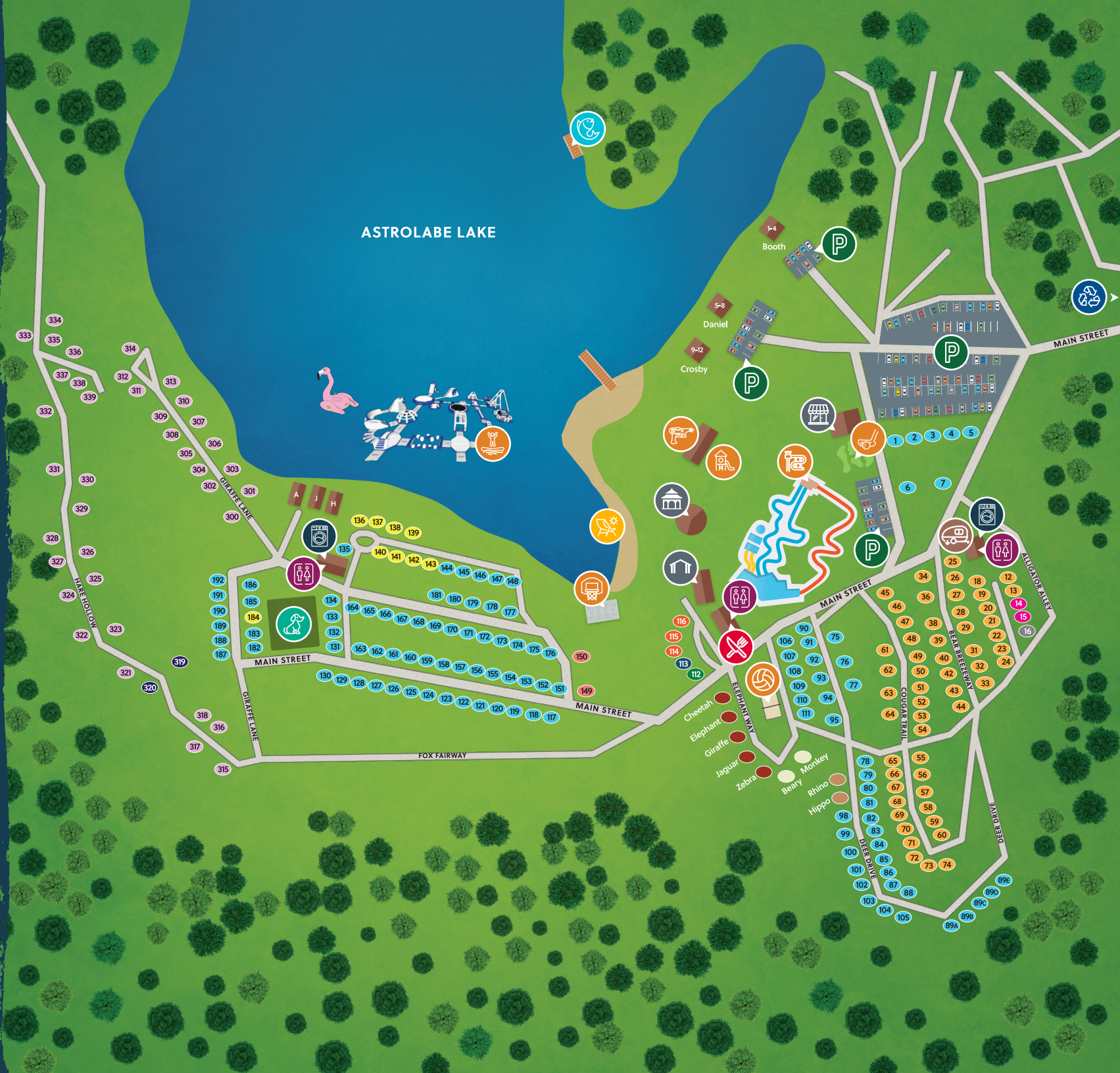

## RESORT AMENITIES

- Store/Office
- Volleyball
- Water Playground
- Basketball Court
- Washrooms
- Parking
- Playground
- Laundry
- Fishing Dock
- Waterpark
- Dump Station
- Recycling
- Shelter
- Mini Golf
- Dog Park
- Safari Snack Shack
- Laser Tag
- Gazebo
- Beach

- Tent Sites
- RV 50 Amp & Hydro
- RV 30 Amp & Hydro
- Tent Trailer Sites 15 Amp
- RV Full Service 30 Amp & Septic
- Rustic Cabins
- Bunkie Sites
- Deluxe Cabins
- Elevation Cabin
- Exhibition Cabin
- Fonhill Cabin
- Clarendon Cabin
- Mongolian Yurt
- XL Bunkie
- Cedar Cabins
- Villas



15906 Hwy 17, Cobden, ON K0J 1K0  
 t. 613.646.9765 w. splashvalley.ca







# RV & Camp Policies



## RATES & OCCUPANCY

- Rates reflect a maximum depending on site or accommodation type. Additional fees apply if you exceed the maximum occupancy.
- Overnight guests are entitled to a discount at our Waterpark. Please let the Admissions staff know you are an overnight guest when purchasing passes. Free Wifi hotspots available in RV Park & Waterpark.
- **WRISTBANDS:** All on-site guests must wear a BASIC PASS wristband at all times. Splash Valley reserves the right to remove anyone without a wristband from the property.
- Gate cards must be returned to the Admissions building when checking out.

## DAY GUESTS

- Visiting day Guests pay general admission rates upon arrival at the ADMISSIONS BUILDING. Visitors must leave by 11pm.
- **Visitors must park in the main parking lot.**

## TENT SITES

- Maximum of 2 sleeping tents, 1 dining tent, and 1 vehicle.

## PETS

- Pets must be contained or leashed on your site.
- Pets are not permitted in the Waterpark, in the lake, or in any buildings at any time.
- You are responsible for your pet's behaviour. Please keep pets quiet to be considerate of other guests.
- Clean up after pets.
- Unruly pets must be removed from the property upon request.

## CONDUCT

- Guests are expected to behave responsibly with regard to other guests, staff, animals and property.
- Firearms, explosives, weapons and fireworks are strictly prohibited. Anywhere. Anytime.
- Recreational Drug use prohibited. Anywhere. Anytime.
- Alcoholic beverages are not to be consumed in common areas such as roadways, play areas, beach areas, trails, and public shelters/buildings. Guests who appear to be intoxicated are subject to immediate removal from the property without refund.
- Smoking is prohibited in buildings, Waterpark, beach and eating area's.
- Foul language will not be tolerated.
- Leave vegetation intact. Do not debark, damage, or remove trees and flowers.
- Leave wildlife other than fish in tact. Please use a catch and release approach when fishing. Do not poach endangered species, specifically turtles. Carry current fishing licence.

## MOTORIZED VEHICLE OPERATION

- Operate only licenced motor vehicles on roads and in parking areas. Dirt bikes, ATV's, mopeds, kid's electric jeeps, etc. are not permitted.

- Park speed limit is **9km/hr.**
- Motorized boats are not permitted on our beautiful spring fed lake.

## WATERPARK, FLOATING WATER PLAYGROUND AND LAKE

- We do not permit the following at the waterfront:
  - Motor boats
  - Pets
  - Glass containers
  - Washing clothing or dishes
  - Alcoholic beverages
- The Floating Water Playground may be accessed with a SPLASH PASS wristband during operating hours. Unauthorized access will result in immediate removal of you and your party from the property with no refund. Security cameras and other measures are in place to ensure your safety.

## CAMPFIRES

- Obey fire ban when posted.
- Contain campfires within the designated fire pit.
- Attend your fire at all times and extinguish before retiring.
- Firewood is available at the ADMISSIONS BUILDING. Outside firewood is not permitted. Please visit Canada Food Inspection Agency website at [inspection.ca](http://inspection.ca) for further information regarding moving firewood and associated penalties.

## GARBAGE

- Place garbage and recycling in the disposal on the main road before exiting the park.
- Place plastic bottles and metal cans in the large recycling bins.
- \$25 will be charged to your credit/debit card for garbage left on your site after your departure.

## SURVEILLANCE

- We employ video surveillance in some public areas to detect, deter, and assist in investigating criminal activity.

**Quiet hours are from 11pm until 7am**

**CHECK IN: AFTER 4PM CHECKOUT: BEFORE 11AM**

*(For a \$20 fee, Late check-out is offered for Campsites and RV sites provided your site is not booked. Please register for late check-out before 10am)*

**15906 Hwy 17, Cobden, Ontario, K0J 1K0 | 613-646-9765**

**IN CASE OF EMERGENCY DIAL 911**

*Thank you for visiting with us!*